

HOSEBED CAPACITIES
 ① 400' OF 3.00" D.J. POLY HOSE
 ② 1000' OF 5.00" D.J. POLY HOSE

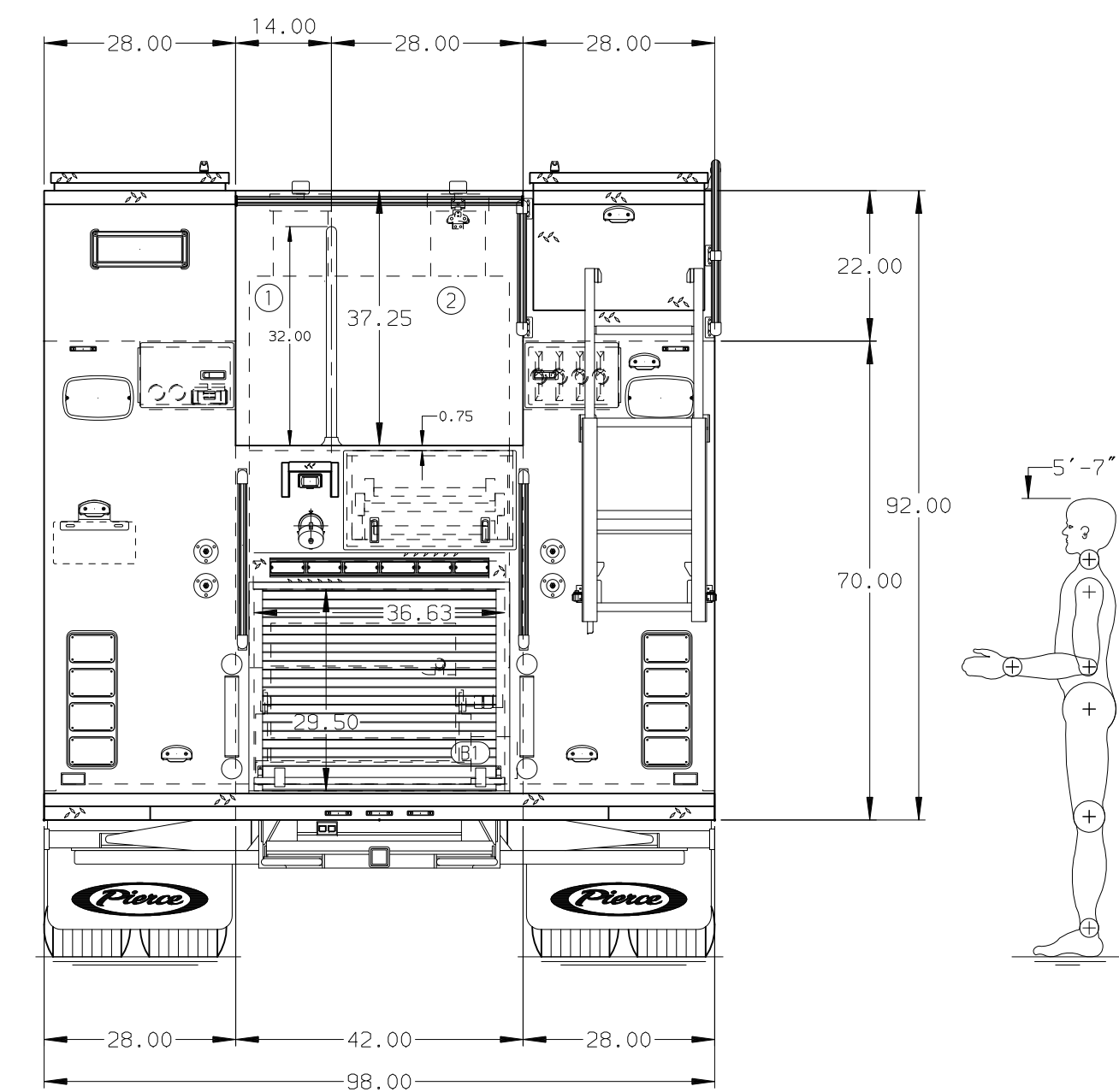
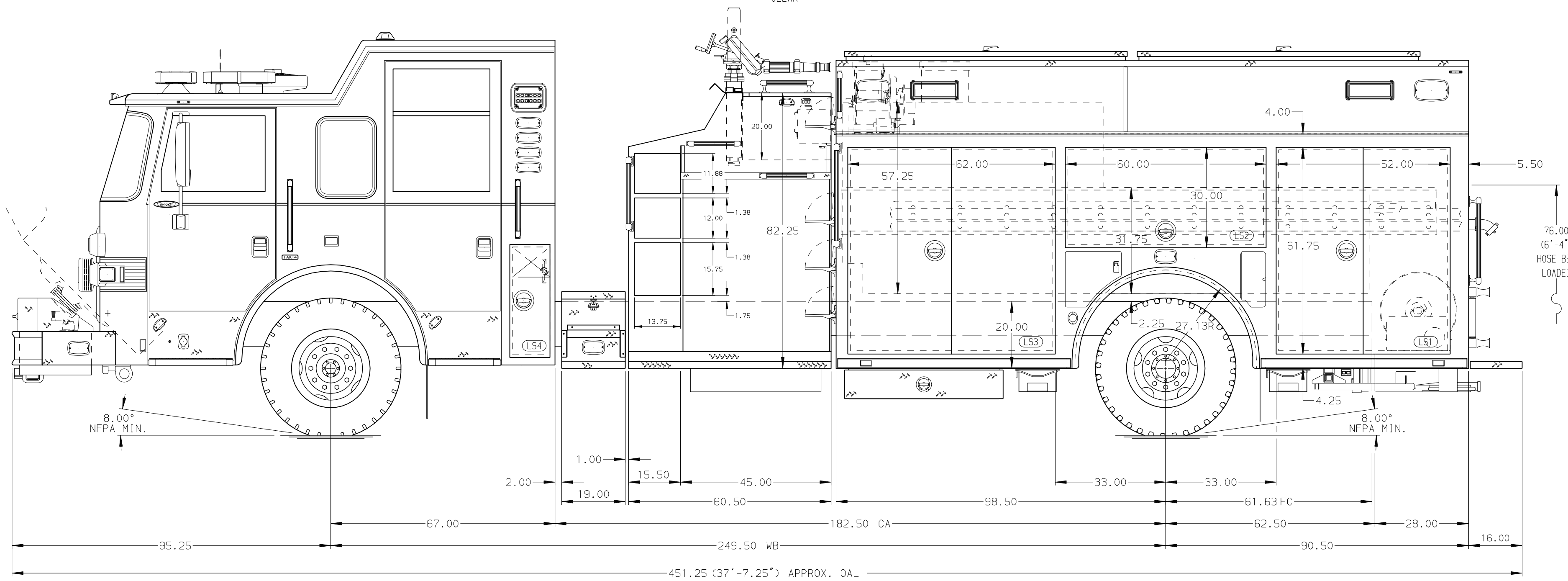

ALUMINUM BODY

NOTE
 DIMENSIONS SHOWN ARE APPROXIMATE
 AND ARE SUBJECT TO MINOR DEVIATIONS
 AS MAY OCCUR OR BE NECESSARY IN
 CONSTRUCTION.
 MINOR DETAILS NOT SHOWN.

CUSTOMER APPROVAL					JOB NO.	PRELIM
APPROVED BY:					SCALE	DATE
DATE:				1:24		
CHASSIS DATA	TITLE	2000-D-750P, 685 GAL WATER W/25 & 40 GAL FOAM CELLS		DRAWN BY	20MAY22	
MAKE	FOR	TOWNSHIP OF LACEY		CHECKED BY	20MAY22	
PIERCE		FIRE & SAFETY SERVICES, LTD		NPA		
MODEL	DWG NO.	05-0505		SHEET SIZE	SHEET NO.	
REV	DATE	BY	CH	D	1 OF 1	