

HOSEBED CAPACITIES

- ① 400' OF 1.75" D.J. POLY HOSE
- ② 500' OF 2.00" D.J. POLY HOSE
- ③ 500' OF 3.00" D.J. POLY HOSE
- ④ 1500' OF 5.00" SNAP-TITE TPX HOSE

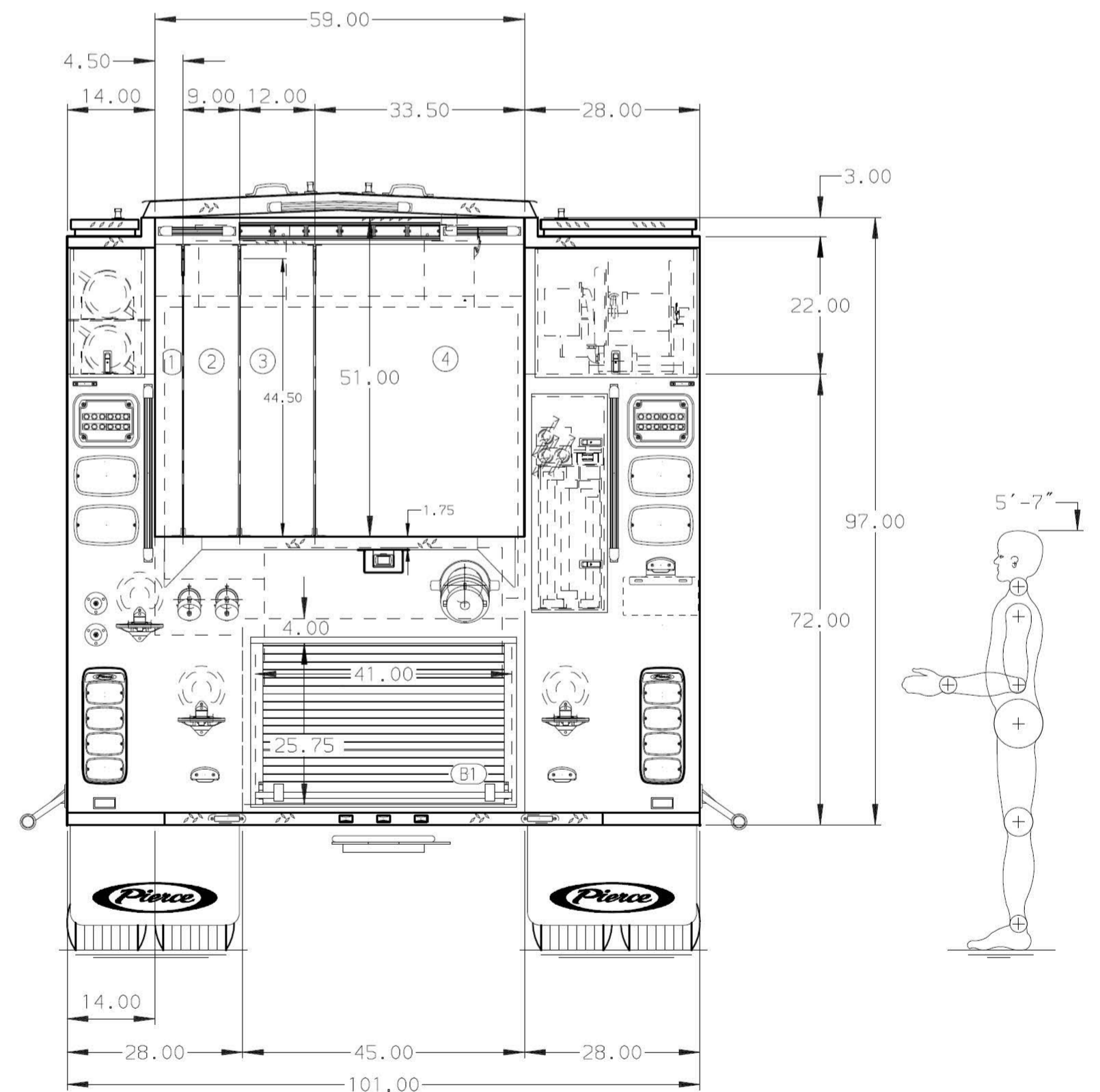

ALUMINUM BODY MAXIMUM O.A.H. 127.00"

NOTE
 DIMENSIONS SHOWN ARE APPROXIMATE AND ARE SUBJECT TO MINOR DEVIATIONS AS MAY OCCUR OR BE NECESSARY IN CONSTRUCTION. MINOR DETAILS NOT SHOWN.

CUSTOMER APPROVAL					JOB NO.	PRELIM	
APPROVED BY: _____						SCALE	DATE
DATE: _____					1:24		
			CHASSIS DATA	TITLE	2000-D-1030P, 1000 GAL. WATER W/30 GAL. FOAM CELL	DRAWN BY	01DEC21
			MAKE	FOR	171" PUMPER BODY, RS FH FDLR, RS FHFD, DELUGE, GENERATOR	CHECKED BY	01DEC21
			PIERCE	FOR	EWING TOWNSHIP FIRE DEPARTMENT	NPA	
			MODEL		FIRE & SAFETY SERVICES, LTD	KEVIN DRISCOLL	
			ENFORCER	DWG NO.	CONCEPTUAL ONLY	SHEET NO.	SHEET NO.
REV	DATE	BY	CH			D	1 OF 1