

- HOSEBED CAPACITIES
- ① 600' OF 3.00" D.J. POLY HOSE
 - ② 400' OF 2.50" D.J. POLY HOSE
 - ③ 1200' OF 5.00" RUBBER HOSE
 - ④ 300' OF 1.75" D.J. POLY HOSE

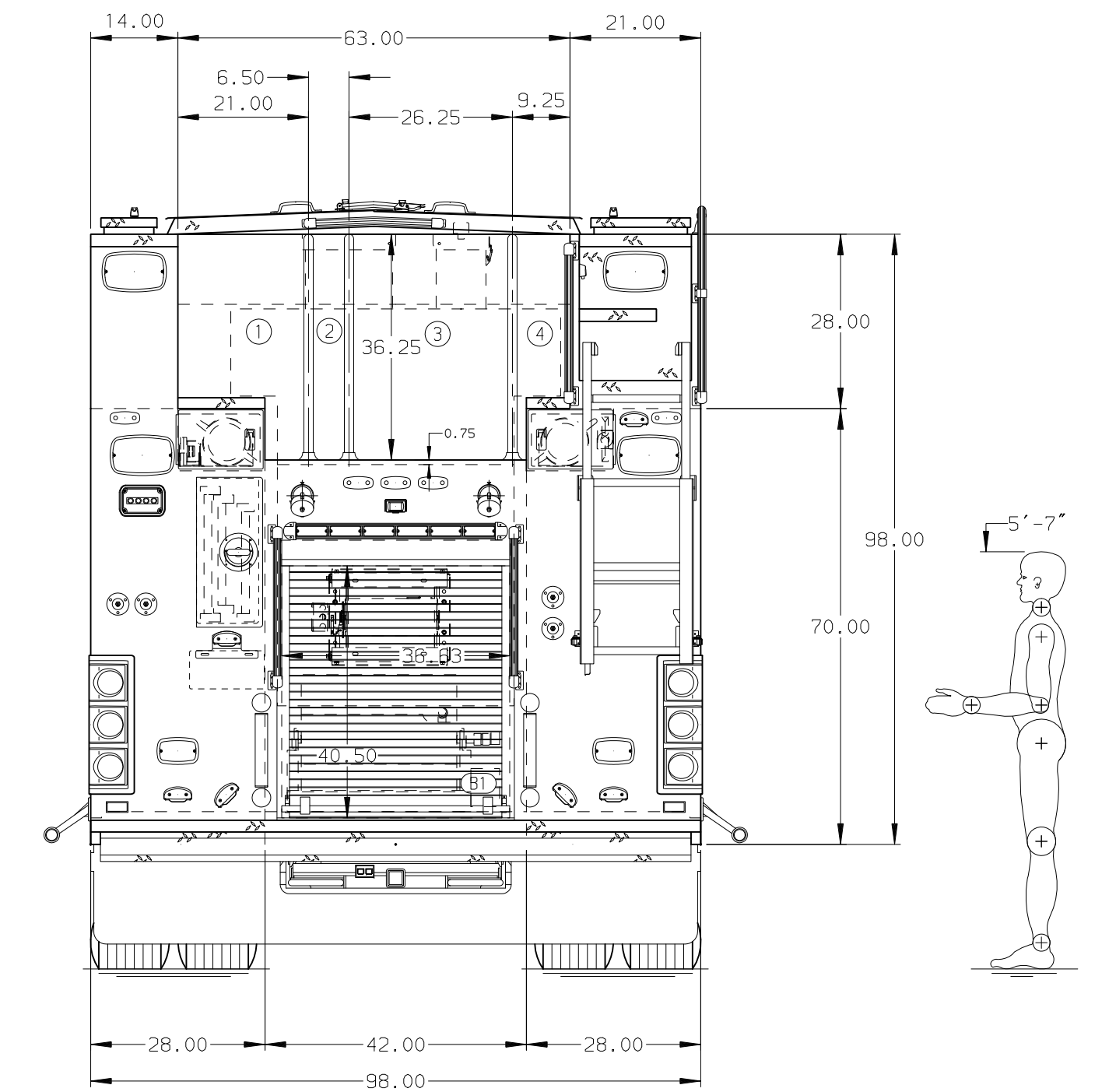
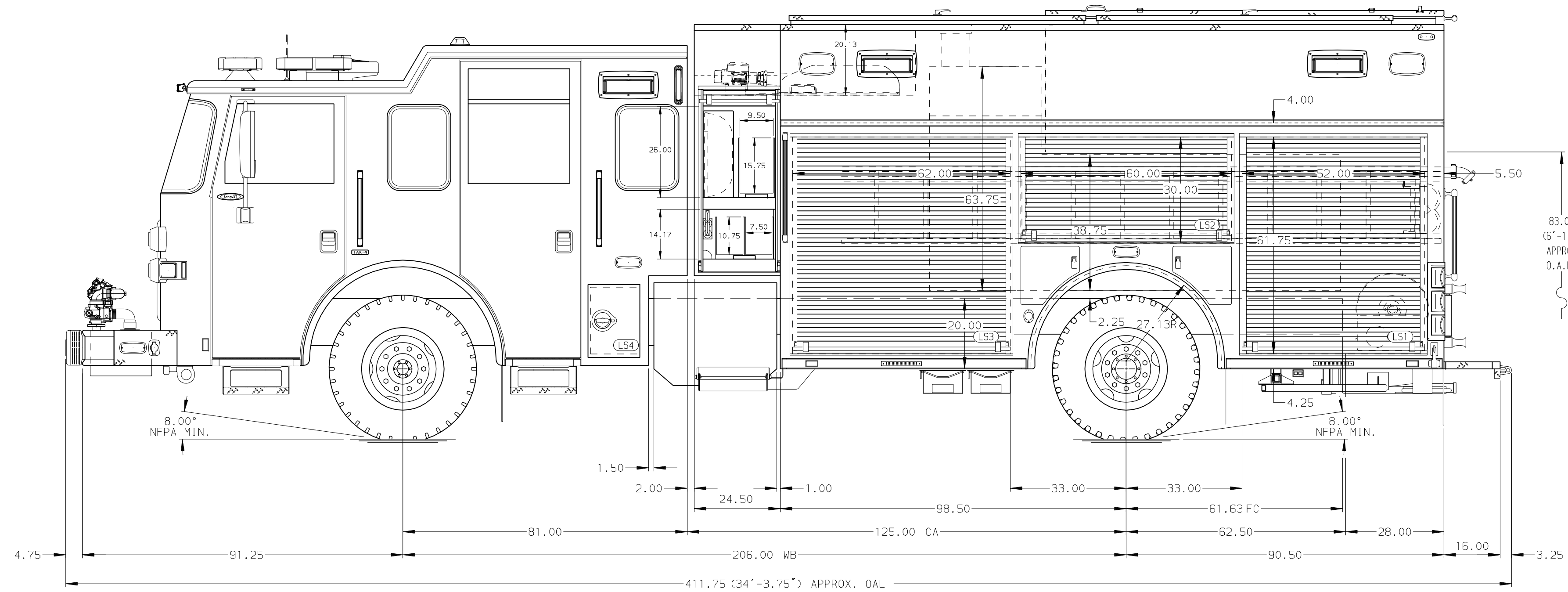

ALUMINUM BODY

NOTE
DIMENSIONS SHOWN ARE APPROXIMATE
AND ARE SUBJECT TO MINOR DEVIATIONS
AS MAY OCCUR OR BE NECESSARY IN
CONSTRUCTION.
MINOR DETAILS NOT SHOWN.

CUSTOMER APPROVAL

APPROVED BY: _____
DATE: _____



JOB NO. PRELIM

SCALE 1:24 DATE

CHASSIS DATA	TITLE	2000-D-750P, 710 GAL WATER W/40 GAL FOAM CELL
MAKE	FOR	189" PUC RESCUE BODY, DELUGE, GENERATOR
PIERCE		BOROUGH OF MONTVALE
MODEL		FIRE & SAFETY SERVICES, LTD
REV	DATE	BY
CH	ARROW	XT
DWG NO.	05-0593	

DRAWN BY BST 23JUN22
CHECKED BY NPA 24JUN22
SHEET SIZE D SHEET NO. 1 OF 1