



Pierce Arrow XT Pumper  
City of Hackensack  
Job #31096

FEATURES & SPECIFICATIONS

- Pierce Arrow XT 67" Chassis with a 10" Raised Roof
- Detroit Diesel DD13 505 hp 2016 EPA compliant Engine
- Allison EVS4000P Automatic Transmission
- Waterous 2000 GPM Two Stage Pump
- Meritor Front and Rear Axles
- 750 Gallon New York Style Poly Tank
- Delivered in November 2017



***FIRE & SAFETY SERVICES, LTD.***

South Plainfield, NJ

web: [www.f-ss.com](http://www.f-ss.com) · phone: 800-400-8017

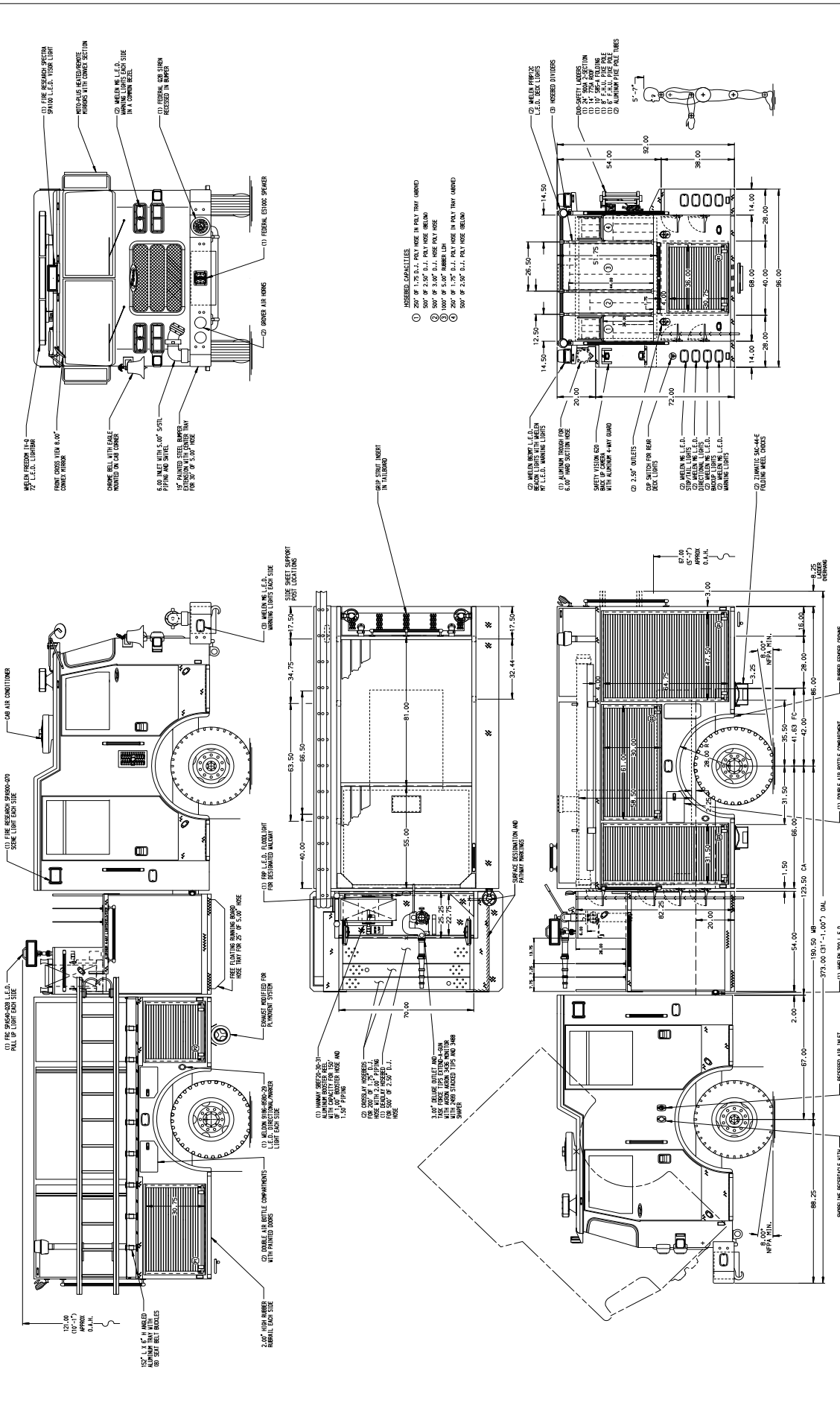

JOB NO.	31096
SCALE	1:24
DATE	
DRAWN BY	CSD
CHECKED BY	CSD
DATE	
SHEET NO.	1 OF 1

<b>Pierce</b>				<b>MANUFACTURING INC.</b>			
CHASSIS DATA	2000-D-750P, 152" FH DS, LOW PS, SIDE CONTROL	MODEL	CSO	222MART7	DATE		
TITLE	(2) X-LAYS, (1) DEAD-LAY, DELUGE, BOOSTER REEL	DATE					
FOR	CITY OF HACKENSACK	COR	PIERCE	COR	CSD	222MART7	
DWG	HACKENSACK, NEW JERSEY	BY	CSD	DATE			
NO.	31096AD	BY	CSD	DATE			
		BY	CSD	DATE			

**STAINLESS STEEL BODY**

NOTE: DIMENSIONS SHOWN ARE APPROXIMATE AND ARE SUBJECT TO MINOR DEVIATIONS AS MAY OCCUR OR BE NECESSARY IN CONSTRUCTION. FINISH DETAILS NOT SHOWN.

- 1. BATTERY COVER MOUNTED BEHIND DRIVER'S SEAT.
- 2. ONE (1) 2" DIA. HOSE END, 15' LONG, IN COMPARTMENT AT REAR.
- 3. ONE (1) 2" DIA. HOSE END, 15' LONG, IN COMPARTMENT AT REAR.
- 4. ONE (1) 2" DIA. HOSE END, 15' LONG, IN COMPARTMENT AT REAR.
- 5. PAINTED SELF-HEALING FINISH APPLIED TO COMPARTMENTS AT REAR.
- 6. ONE (1) 2" DIA. HOSE END, 15' LONG, IN COMPARTMENT AT REAR.
- 7. ONE (1) 2" DIA. HOSE END, 15' LONG, IN COMPARTMENT AT REAR.
- 8. ONE (1) 2" DIA. HOSE END, 15' LONG, IN COMPARTMENT AT REAR.
- 9. ONE (1) 2" DIA. HOSE END, 15' LONG, IN COMPARTMENT AT REAR.

**WELDED CAPACITIES:**

- 1. 300" OF 2.50" O.D. S.S. HOSE FOR USE IN POLY PUMP (HARD)
- 2. 300" OF 3.00" O.D. S.S. HOSE FOR USE IN POLY PUMP (HARD)
- 3. 300" OF 3.00" O.D. S.S. HOSE FOR USE IN POLY PUMP (HARD)
- 4. 300" OF 3.00" O.D. S.S. HOSE FOR USE IN POLY PUMP (HARD)

**WELDED CAPACITIES:**

- 1. 300" OF 2.50" O.D. S.S. HOSE FOR USE IN POLY PUMP (HARD)
- 2. 300" OF 3.00" O.D. S.S. HOSE FOR USE IN POLY PUMP (HARD)
- 3. 300" OF 3.00" O.D. S.S. HOSE FOR USE IN POLY PUMP (HARD)
- 4. 300" OF 3.00" O.D. S.S. HOSE FOR USE IN POLY PUMP (HARD)

**WELDED CAPACITIES:**

- 1. 300" OF 2.50" O.D. S.S. HOSE FOR USE IN POLY PUMP (HARD)
- 2. 300" OF 3.00" O.D. S.S. HOSE FOR USE IN POLY PUMP (HARD)
- 3. 300" OF 3.00" O.D. S.S. HOSE FOR USE IN POLY PUMP (HARD)
- 4. 300" OF 3.00" O.D. S.S. HOSE FOR USE IN POLY PUMP (HARD)